

**Contact us**  
ABB STOTZ-KONTAKT GmbH  
Eppelheimer Str. 82  
69123 Heidelberg  
Germany  
www.abb.com/lowvoltage



Warning! Installation by person with  
electrotechnical expertise only.  
Warnung! Installation nur durch  
elektrotechnische Fachkraft.  
Avvertenza! Fare installare solo  
da un elettricista qualificato.

de Arbeitsstromauslöser  
en Shunt trip  
fr Bloc déclencheur  
it Bobina di apertura a lancio di corrente  
es Bobina de emisión de corriente  
cn 分励脱扣器  
ru Дистанционный расцепитель

0.8 Nm  
1 wire 0.75 ... 2.5 mm<sup>2</sup>/AWG 18-14  
2 wires max. 2x1.5mm<sup>2</sup>/AWG 18-16  
max. 2 wires per slot  
7 ... 8 mm/0.28 ... 0.32 In  
CU only

S200  
S200 M  
S200 MT/S200 MTR  
S200 P  
S200 MUC  
S300 P  
VY30

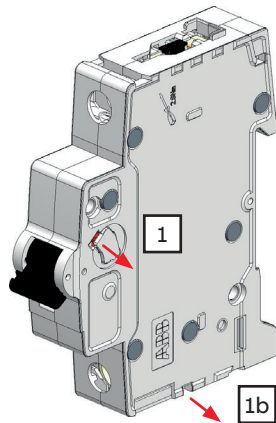

1b Remove only for S300 P, S200 MTR

F200  
RCCB VY

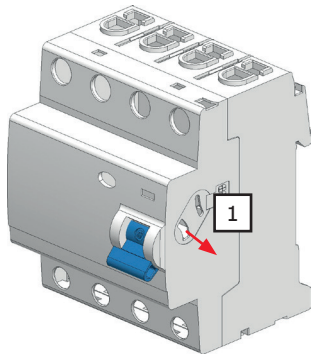

Shunt trip  
Arbeitsstromauslöser

**INSTALLATION AND  
OPERATING INSTRUCTION**

S3C-A1 2CDS200982R0001  
S3C-A2 2CDS200982R0002

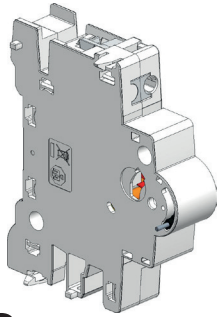

**ABB**

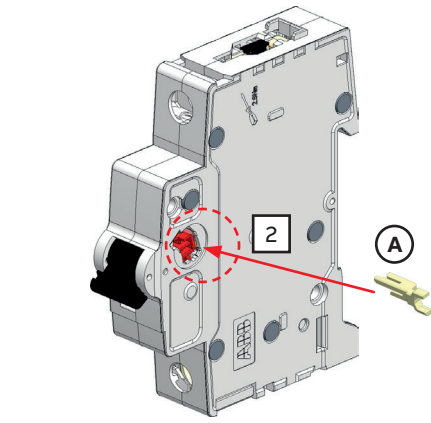

2 Use fork A

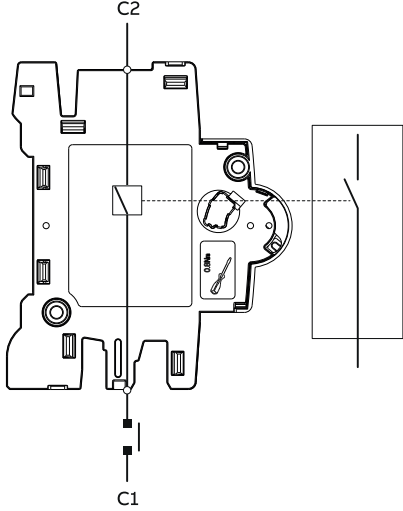
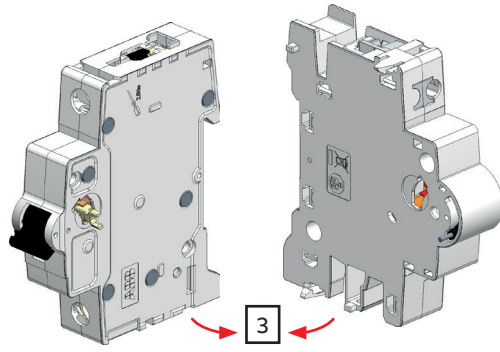

A S200  
S200 M  
S200 MT/S200 MTR  
S200 P  
S200 MUC  
S300 P  
VY30

UP  
DOWN  
Color: White

B F200  
RCCB VY  
SN201  
DS203NC

Color: Black

C S-ARC1  
DS-ARC1  
DSE201 M  
DS201  
S3C-MOD  
F3C-AR

UP  
DOWN  
Color: Blue

S200  
S200 M  
S200 MT/S200 MTR  
S200 P  
S200 MUC  
S300 P  
VY30

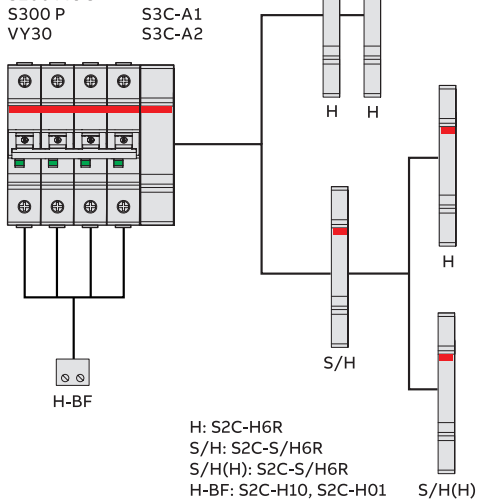

F200  
RCCB VY

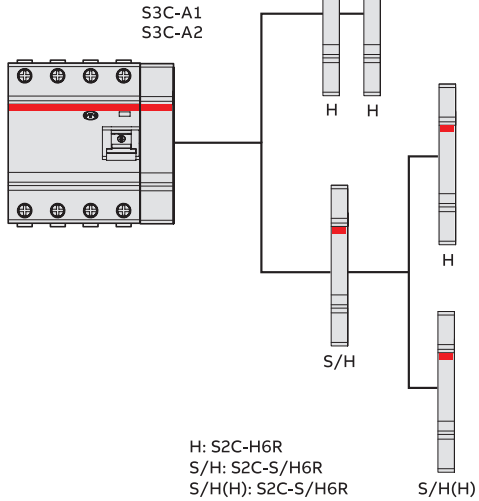

S-ARC1  
DS-ARC1  
DSE201 M  
DS201  
S3C-MOD  
F3C-AR

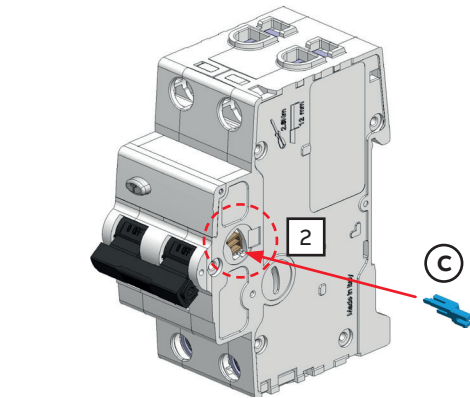
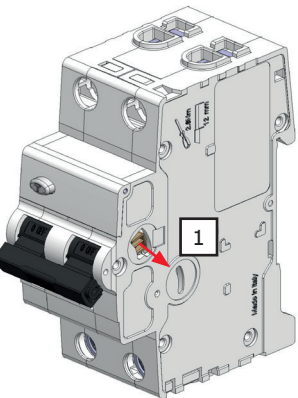

2 Use fork C

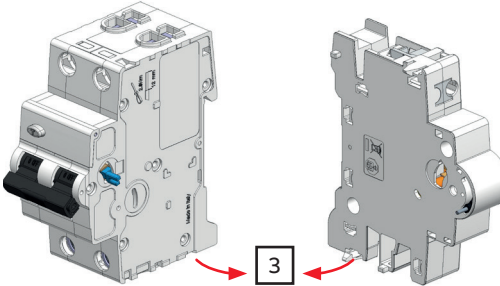

S3C-A1  
S3C-A2

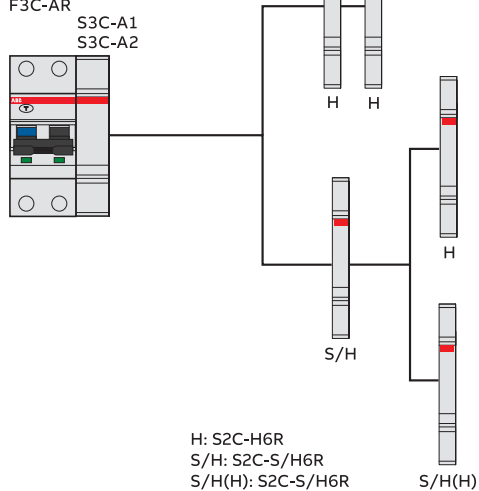

SN201 + SN201-IH  
DS203NC + SN201-IH

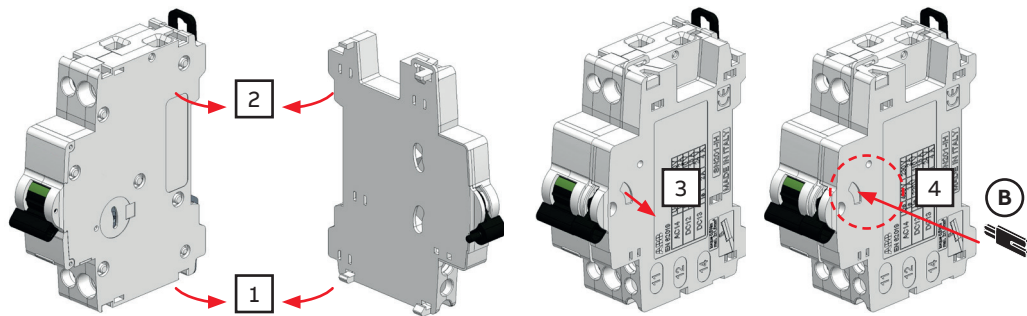

4 Use fork B

DS301C + SCC-IH6R/SCC-S6R  
SN201 + SCC-IH6R/SCC-S6R  
DS203NC + SCC-IH6R/SCC-S6R

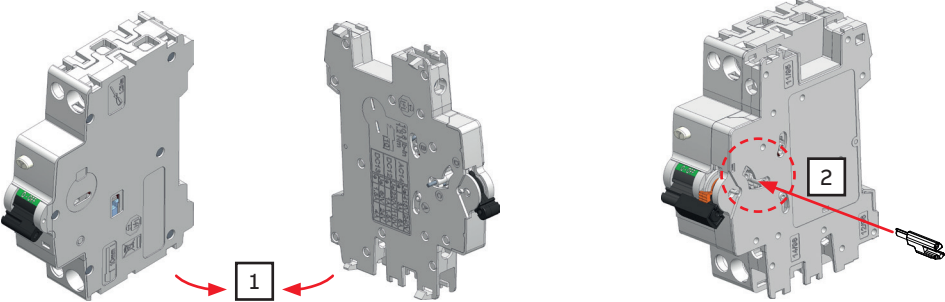

1 Check the instruction sheet of SCC-IH6R/SCC-S6R for more detailed information

2 For this step, use the fork included in the package of SCC-IH6R/SCC-S6R

		S3C-A1				
Rated voltage	AC	V	12...110			
	DC	V	12...110			
Max. release duration		ms	<10 @ Rated voltage			
Min. release voltage	AC	V	8.4			
	DC	V	10			
Power consumption	Ub	V	12 V DC	12 V AC	24 V DC	24 V AC
	Ib <sub>max</sub> /A	A	2.8	3.3	5.3	6.2
	Ub	V	60 V DC	60 V AC	110 V DC	110 V AC
	Ib <sub>max</sub> /A	A	14	15	25.3	25
Coil resistance		Ω	4			
Tightening torque		Nm	0.8			
Dimensions (H x D x W)		mm	85 x 74.1 x 17.4			

		S3C-A2				
Rated voltage	AC	V	110...415			
	DC	V	110...250			
Max. release duration		ms	<10 @ Rated voltage			
Min. release voltage	AC	V	77			
	DC	V	77			
Power consumption	Ub	V	110 V DC	110 V AC	220 V DC	
	Ib <sub>max</sub> /A	A	0.5	0.7	1.1	
	Ub	V	230 V AC	250 V DC	415 V AC	
	Ib <sub>max</sub> /A	A	1.5	1.2	2.5	
Coil resistance		Ω	210			
Tightening torque		Nm	0.8			
Dimensions (H x D x W)		mm	85 x 74.1 x 17.4			

Busbar PS pass-through TOP and BOTTOM ✓  
Caution: When using S3C-A1 and S3C-A2 with OTHER busbar types, make sure that routing cable is not contacting with the pin of the busbar. Take into account also high bending radius.

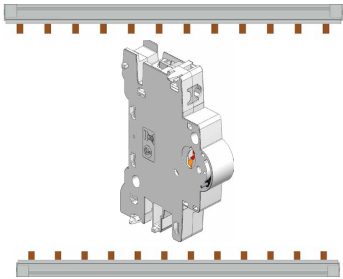

Caution: When positioning the device on the edge, it must be positioned outside the busbar.  
Protection against contact with the connection pins of the busbar must be ensured through suitable selection of the busbar, device positioning and covers.

SN201  
DS203NC

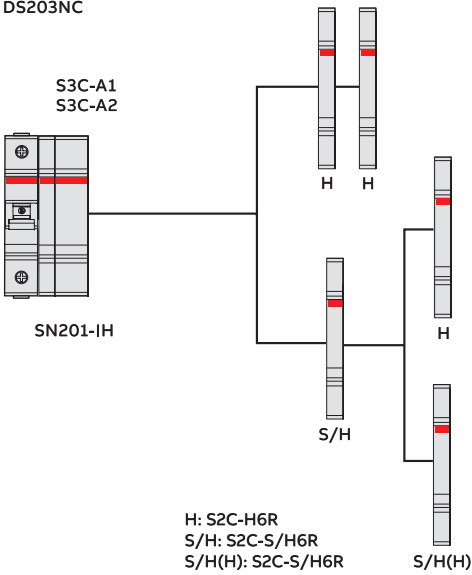

DS301C  
SN201  
DS203NC

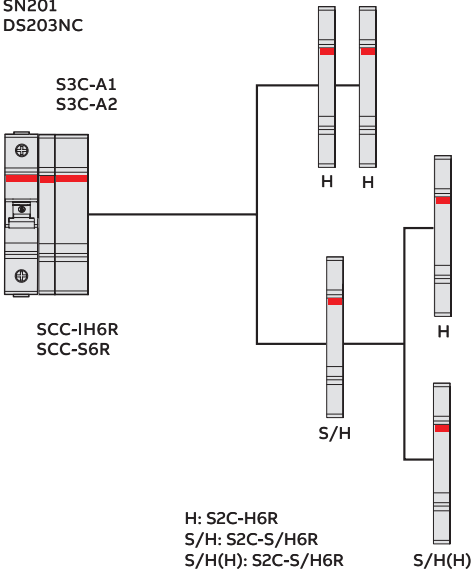

Dimensional drawing

